



# **Analog Camera Technical Manual**

## Notices

---

The information in this documentation is subject to change without notice and does not represent any commitment on behalf of HIKVISION. HIKVISION disclaims any liability whatsoever for incorrect data that may appear in this documentation. The product(s) described in this documentation are furnished subject to a license and may only be used in accordance with the terms and conditions of such license.

Copyright © 2006-2012 by HIKVISION. All rights reserved.

**This documentation is issued in strict confidence and is to be used only for the purposes for which it is supplied.** It may not be reproduced in whole or in part, in any form, or by any means or be used for any other purpose without prior written consent of HIKVISION and then only on the condition that this notice is included in any such reproduction. No information as to the contents or subject matter of this documentation, or any part thereof, or arising directly or indirectly therefrom, shall be given orally or in writing or shall be communicated in any manner whatsoever to any third party being an individual, firm, or company or any employee thereof without the prior written consent of HIKVISION. Use of this product is subject to acceptance of the HIKVISION agreement required to use this product. HIKVISION reserves the right to make changes to its products as circumstances may warrant, without notice.

**This documentation is provided “as-is,” without warranty of any kind.**

Please send any comments regarding the documentation to:

[overseabusiness@hikvision.com](mailto:overseabusiness@hikvision.com)

Find out more about HIKVISION at [www.hikvision.com](http://www.hikvision.com)

## DS-2CC1197P(N)-A(-C)



### Key Features

- Compact design
- SONY Super HAD CCD II
- Flickerless mode
- 75dB Wide Dynamic Range, suitable for strong backlight environment
- 3D-Digital Noise Reduction (3D-DNR)
- Smart IR mode
- Eclipse
- Electronic image stabilization (EIS)
- Min. illumination: 0.001 Lux @ F1.2 (Color) , 0.0001 Lux @ F1.2 (B/W)
- IR cut filter with auto switch
- OSD menu
- Auto iris with DC/video drive
- Auto white balance, auto gain control, electronic shutter control and backlight compensation
- Internal or Power Synchronization
- Convenient back focus adjustment

### Specification

Parameter	Model	DS-2CC1197P(N)-A(-C)
		650 TVL CCD WDR ICR Box Camera
Camera		
Image Sensor		1/3" SONY Super HAD CCD II
Signal System		PAL/NTSC
Effective Pixels		PAL: 976 (H) × 582 (V) NTSC: 976 (H) × 494 (V)

Min. Illumination	Color: 0.001 Lux @ (F1.2, AGC ON), 0.0001 Lux @ (F1.2, AGC ON, sensitivity × 512) B/W: 0.0001 Lux @ (F1.2, AGC ON), 0.00001 Lux @ (F1.2, AGC ON, sensitivity × 512)
Shutter speed	PAL: 1/50 s to 1/100,000 s NTSC: 1/60 s to 1/100,000 s
Lens Mount	C/CS mount
Auto Iris	DC/Video drive
Day & Night	IR cut filter with auto switch
Horizontal Resolution	650 TVL (Color), 700 TVL (B/W)
Wide Dynamic Range	75 dB
Synchronization	Internal/Power synchronization
Video Output	1Vp-p composite output (75 Ω/BNC)
S/N Ratio	More than 62 dB
<b>Menu</b>	
Camera ID	On/Off (16 letters, position adjustable)
Auto Gain	Low/Middle/High/Off
D/N Mode	Auto1/Auto2/Day/Night
White Balance	Auto trace WB1/Auto trace WB2/Manual/Auto Control
Private Mask	On/Off, maximum 12 zones
Motion Detection	Mode 1/Mode 2/Off
BLC	Area/Value/Off
WDR	Value/ Contrast / WD exposure compensation/ Return
RS-485	Address/Protocol/Baud Rate
Anti-Flicker	On/Off
Language	English/Chinese
Function	SMART IR, Eclipse, Digital Noise Reduction, Sharpness, Brightness, Saturation, Resolution, Electronic image stabilization, Digital Zoom, Mirror, Defect Pixel Correction, auto-iris correction
Scene	Indoor Standard , Indoor Backlight , Outdoor, Low illumination , Customize
<b>General</b>	
Working Temperature/Humidity	-10 °C - 60 °C (14 °F - 140 °F) Humidity 90% or less (non-condensing)
Power Supply	24 V AC ± 10%, 12 V DC ± 10% (-C series support 100 - 240 V AC)
Power Consumption	Max. 5 W (Max. 10 W with IR cut filter on)
Dimensions	69 x 56 x 113.3 mm (2.72" × 2.20" × 4.46")
Weight	400 g (0.88 lbs)

## Order Models

DS-2CC1197P-A      DS-2CC1197N-A  
DS-2CC1197P-C      DS-2CC1197N-C

## Dimensions

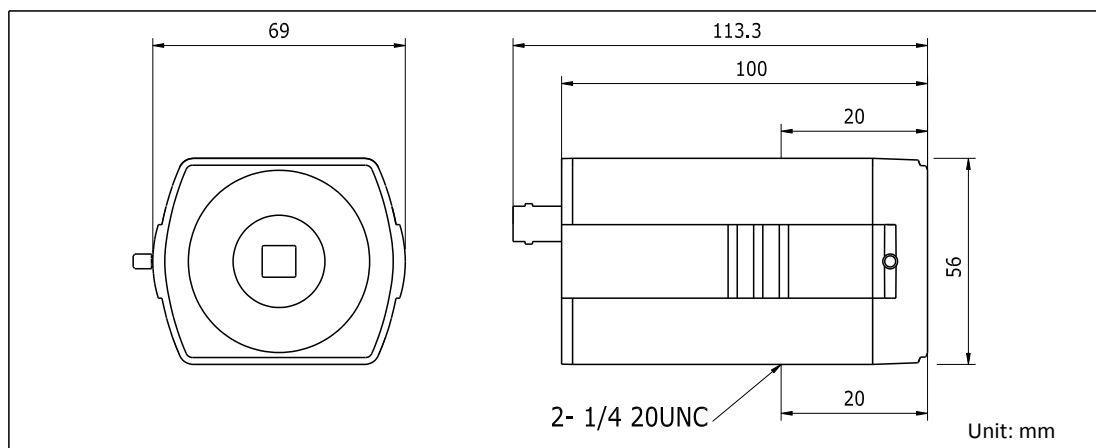

## Accessories



Indoor wall mount  
DS-1212ZJ



Indoor/outdoor wall mount  
DS-1213ZJ



Indoor/outdoor camera housing  
DS-1311HZ (DS-1312HZ, DS-1313HZ)



Indoor camera housing  
DS-1320HZ